

PORT OF TACOMA REPLACEMENT OF RAILWAY TRACK AT
BUBBLE TRACK 1

3204 PORT OF TACOMA ROAD
TACOMA, WASHINGTON

ABBREVIATIONS

BC	BOTTOM OF CURB
BW	BACK OF WALK
C&G	CURB & GUTTER
CB	CATCH BASIN
CL	CENTERLINE
CO	CLEANOUT
CONC	CONCRETE
CONST	CONSTRUCTION
DIA, Ø	DIAMETER
DIP	DUCTILE IRON PIPE
D/W	DRIVEWAY
E	EAST, EASTING
EX/EXIST	EXISTING
FF	FINISH FLOOR
FL	FLOW LINE
HP	HIGH POINT
IE	INVERT ELEVATION
LF	LINEAR FOOT
LT	LEFT
LP	LOW POINT
MECH	MECHANICAL
MH	MANHOLE
N	NORTH, NORTHING
NTS	NOT TO SCALE
P	POWER
PC	POINT OF CURVATURE
PCC	POINT OF COMBINED CURVATURE
P, P/L	PROPERTY LINE
PRC	POINT OF REVERSED CURVATURE
PT	POINT OF TANGENCY
PVC	POLYVINYL CHLORIDE/POINT OF VERTICAL CURB
R	RADIUS
RT	RIGHT
RTO	RETURN TO OWNER
ROW	RIGHT-OF-WAY
S	SOUTH
SD	STORM DRAIN
SS	SANITARY SEWER
STA	STATION
S/W	SIDEWALK
T	TELEPHONE
TC	TOP OF CURB
TP	TYPICAL
U	UNDERGROUND
W	WATER/WEST
W/	WITH
Ø	AT

GENERAL PLAN NOTES

- COORDINATE ALL WORK WITH ON-SITE DOCUMENTS.
- THE CONTRACTOR SHALL BE RESPONSIBLE FOR PROVIDING ADEQUATE SAFEGUARDS, SAFETY DEVICES, PROTECTIVE EQUIPMENT, FLAGGERS AND ANY OTHER NEEDED ACTIONS TO PROTECT THE LIFE, HEALTH AND SAFETY OF THE PUBLIC. ANY WORK WITHIN THE TRAVELED RIGHT-OF-WAY THAT MAY INTERRUPT NORMAL TRAFFIC FLOW SHALL REQUIRE NOTIFICATION AND COORDINATION WITH THE CITY OF TACOMA.
- ALL MATERIALS AND CONSTRUCTION SHALL BE IN ACCORDANCE WITH THE 2010 WASHINGTON STATE DEPARTMENT OF TRANSPORTATION (WSDOT) STANDARD SPECIFICATIONS FOR ROAD, BRIDGE AND MUNICIPAL CONSTRUCTION AS MODIFIED FOR USE BY THE CITY OF TACOMA AND THE CITY OF TACOMA STANDARD PLANS. A COPY OF THE APPROVED PLANS AND SPECIFICATIONS SHALL BE ON-SITE WHENEVER CONSTRUCTION IS IN PROGRESS.
- PRIOR TO CONSTRUCTION, THE CONTRACTOR SHALL OBTAIN ALL PERMITS REQUIRED FOR WORK WITHIN THE PUBLIC RIGHT-OF-WAY.
- ALL LOCATIONS OF EXISTING UTILITIES SHOWN HEREON HAVE BEEN ESTABLISHED BY FIELD SURVEY OR OBTAINED FROM AVAILABLE RECORDS AND SHOULD THEREFORE BE CONSIDERED APPROXIMATE ONLY AND NOT NECESSARILY COMPLETE. IT IS THE SOLE RESPONSIBILITY OF THE CONTRACTOR TO INDEPENDENTLY VERIFY THE ACCURACY OF ALL UTILITY LOCATIONS SHOWN AND TO FURTHER DISCOVER AND AVOID ANY OTHER UTILITIES NOT SHOWN HEREON WHICH MAY BE AFFECTED BY THE IMPLEMENTATION OF THIS PLAN.
- THE CONTRACTOR SHALL VERIFY THE LOCATIONS OF UTILITIES BY CONTACTING A UTILITY LOCATE SERVICE AND SHALL PROVIDE SUFFICIENT NOTIFICATION TO THE AFFECTED UTILITY COMPANIES PRIOR TO STARTING WORK. COORDINATE WORK FOR EXISTING UTILITIES WITH CONTACTS SHOWN IN THE UTILITY CONTACTS TABLE. CONTACT UNDERGROUND UTILITIES LOCATION AT 1-800-424-5555 AT LEAST 48 HOURS BEFORE COMMENCEMENT OF CONSTRUCTION.
- THE CONTRACTOR SHALL NOTIFY THE TACOMA FIRE DEPARTMENT (253) 591-5737 24 HOURS IN ADVANCE OF ALL WATER SERVICE INTERRUPTIONS, HYDRANT SHUTOFFS, AND STREET CLOSURES OR OTHER ACCESS BLOCKAGE. THE CONTRACTOR SHALL ALSO NOTIFY THE FIRE DEPARTMENT OF ALL NEW, RELOCATED, OR ELIMINATED HYDRANTS RESULTING FROM THIS WORK.
- THE CONTRACTOR SHALL MAINTAIN EMERGENCY VEHICLE ACCESS ON ALL AFFECTED STREETS AT ALL TIMES.
- MAINTAIN AND PROTECT ALL MANHOLES, CATCH BASINS, FIRE HYDRANTS, MONITORING WELLS, WATER VALVES, PIPING, SURVEY MONUMENTS, TRAFFIC CONTROL BOXES, WATER METERS AND ENGINEER OTHER IMPROVEMENTS UNLESS OTHERWISE NOTED ON THE PLANS. CONTRACTOR SHALL REPAIR OR REPLACE ALL ITEMS DAMAGED BY THE CONSTRUCTION OPERATIONS AT NO ADDITIONAL COST TO THE OWNER.
- THESE PLANS ARE APPROVED FOR CONSTRUCTION FOR A PERIOD OF 24 MONTHS FROM THE DATE OF CITY APPROVAL. THE CITY RESERVES THE RIGHT TO REQUIRE REVISIONS, ADDITIONS, DELETIONS, OR MODIFICATIONS SHOULD CONSTRUCTION BE DELAYED BEYOND THIS TIME LIMITATION OR IF FIELD CONDITIONS ARE DIFFERENT FROM WHAT IS DEPICTED ON THESE PLANS.
- THE CONTRACTOR IS RESPONSIBLE FOR PROVIDING A TRAFFIC CONTROL PLAN TO THE CITY THAT MEETS THE CRITERIA OF THE CITY OF TACOMA TRAFFIC CONTROL HANDBOOK AND RIGHT-OF-WAY DESIGN MANUAL. CONTACT PUBLIC WORKS TRAFFIC ENGINEER, PHONE # (253) 591-5554 FOR SPECIFIC TRAFFIC CONTROL REQUIREMENTS FOR THIS PROJECT. A TRAFFIC CONTROL PLAN SHALL BE SUBMITTED AND APPROVED PRIOR TO COMMENCING WORK.
- CONTRACTOR SHALL VERIFY ALL UTILITY POINTS OF CONNECTIONS TO EXISTING UTILITIES PRIOR TO CONSTRUCTION AND NOTIFY ENGINEER OF ANY DISCREPANCY.
- EXCAVATED MATERIAL MEETING PROJECT SPECIFICATIONS MAY BE USED FOR BACKFILL. NO STOCKPILING OF EXCAVATED MATERIAL IS ALLOWED WITHIN THE PROJECT LIMITS.
- REMOVE AND REPLACE ALL BROKEN, DAMAGED, OR HAZARDOUS SIDEWALK, CURB AND GUTTER, AND DRIVEWAYS.
- RESTORATION SHALL BE IN ACCORDANCE WITH THE CITY OF TACOMA ROW RESTORATION POLICY AS ADOPTED JUNE 2, 2009.
- THE ENGINEER OF RECORD SHALL PROVIDE AN ENGINEER'S CERTIFICATION TO THE CITY OF TACOMA AFTER FACILITY INSTALLATION AND PRIOR TO PERMIT FINAL INSPECTION AND/OR CLOSEOUT. THE ENGINEER'S CERTIFICATION SHALL INCLUDE:
 - THE PERMIT NUMBER
 - STATEMENTS TO ATTEST:
 - THAT ALL STORMWATER FACILITIES HAVE BEEN INSTALLED ACCORDING TO THE APPROVED PERMIT DOCUMENTS. CHANGES TO THE APPROVED PERMIT SET THAT ARE REQUIRED DURING CONSTRUCTION SHALL BE SUBMITTED TO BLUS FOR ESSE TO REVIEW AND APPROVAL DURING THE CONSTRUCTION PHASE AND PRIOR TO THE CHANGE BEING CONSTRUCTED.
 - AS-BUILT DRAWINGS HAVE BEEN PROVIDED TO THE CITY ELECTRONICALLY. THESE SHALL BE PROFESSIONALLY DRAFTED ENGINEERING DRAWINGS THAT ARE STAMPED, SIGNED, AND DATED BY A WASHINGTON STATE LICENSED ENGINEER. THE DRAWINGS MUST ACCURATELY REPRESENT THE PROJECT AS CONSTRUCTED.
 - THE OPERATIONS AND MAINTENANCE MANUAL IS LOCATED ONSITE.

THE ENGINEER'S CERTIFICATION SHALL BE SUBMITTED TO ENVIRONMENTAL SERVICES / PLAN REVIEW LEAD / 326 EAST D STREET / TACOMA, WA 98421. FOR SITE AND BUILDING PERMITS SEND A COPY OF THE CERTIFICATION TO BUILDING AND LAND USE SERVICES 747 MARKET STREET, ROOM 345, TACOMA, WA 98402.

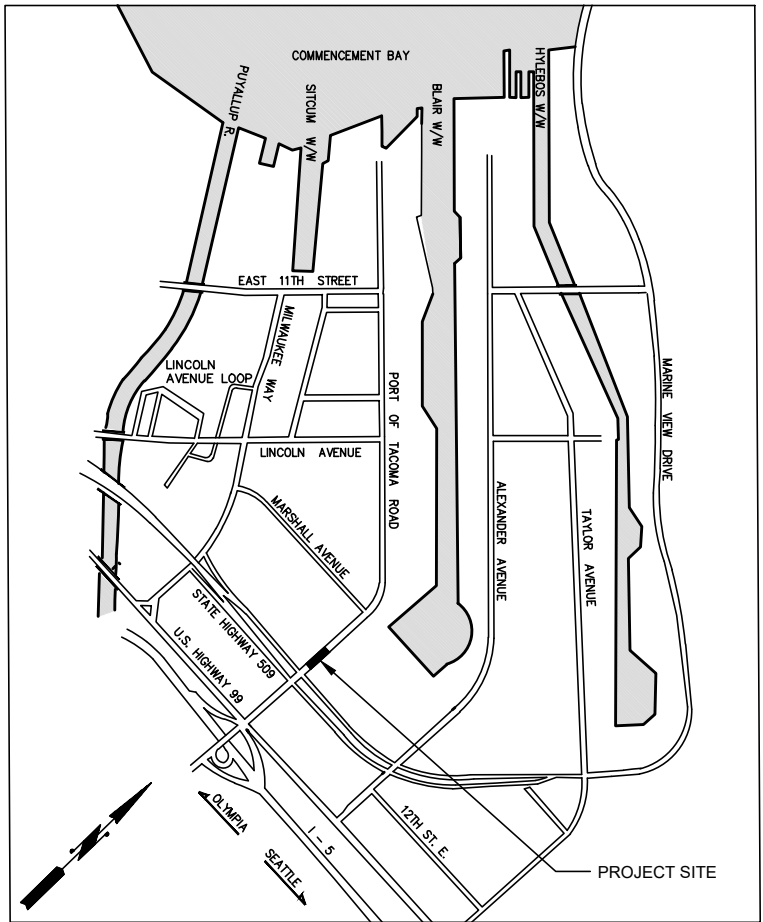

VICINITY MAP

NTS

TRAFFIC CONTROL NOTES

LOCATION: UNDERNEATH PORT OF TACOMA ROAD OVERPASS, 3204 PORT OF TACOMA ROAD
THE FOLLOWING SPECIAL TRAFFIC CONTROLS SHALL SUPPLEMENT SECTION 1-07.23 OF THE STANDARD SPECIFICATIONS.

- BIDIRECTIONAL TRAFFIC TO BE MAINTAINED ON PORT OF TACOMA ROAD THROUGHOUT THE DURATION OF PROJECT. THE IMPACTED PORTION OF PORT OF TACOMA ROAD (BELOW THE OVERPASS) IS CLOSED TO PUBLIC TRAFFIC AND IS ANTICIPATED TO REMAIN SO THROUGH CONSTRUCTION. THE CONTRACTOR IS RESPONSIBLE FOR PROVIDING A TRAFFIC CONTROL PLAN TO THE CITY THAT MEETS THE CITY OF TACOMA TRAFFIC CONTROL HANDBOOK AND RIGHT-OF-WAY DESIGN MANUAL. CONTACT TRAFFIC DEPARTMENT, PHONE NUMBER (253) 591-5554, FOR SPECIFIC TRAFFIC CONTROL REQUIREMENTS FOR THIS PROJECT. A TRAFFIC CONTROL PLAN SHALL BE SUBMITTED AND APPROVED PRIOR TO COMMENCING WORK.
- WHEN NECESSARY, AND JUSTIFIED, SINGLE LANES OF TRAFFIC MAY BE CLOSED DURING SPECIFIED HOURS OF THE DAY. THE DETERMINATION OF THESE HOURS SHALL BE IN CONSULTATION WITH AND SUBJECT TO THE APPROVAL OF THE CITY TRAFFIC ENGINEER AND PORT OF TACOMA. PROVIDED THAT LOCAL ACCESS IS MAINTAINED AT ALL TIMES WITH A MINIMUM OF A 12-FOOT WIDE ACCESS LANE FOR EACH DIRECTION OF TRAFFIC. THE CONTRACTOR SHALL COORDINATE ANY LANE CLOSURES AND COOPERATE WITH THE VARIOUS BUSINESSES AND/OR RESIDENCES ADJACENT TO THE PROJECT SITE. A MINIMUM OF ONE ACCESS SHALL BE MAINTAINED TO ALL PROPERTIES AND DRIVEWAYS ON PORT OF TACOMA ROAD AT ALL TIMES.

THREE (3) WORKING DAYS PRIOR TO ANY LANE CLOSURE, THE CONTRACTOR SHALL NOTIFY:

TACOMA PUBLIC WORKS ENGINEERING DIVISION	(253-591-5500)
TACOMA PUBLIC WORKS STREETS AND GROUNDS	(253-591-5495)
TACOMA PUBLIC WORKS SOLID WASTE	(253-591-5544)
TACOMA FIRE DEPARTMENT	(253-591-5733)
TACOMA POLICE DEPARTMENT	(253-591-5951)
LESA COMMUNICATION CENTER	(253-798-4721-Opt.#3)
TACOMA PUBLIC SCHOOLS TRANSPORTATION OFFICE	(253-571-1853)
PIERCE TRANSIT	(253-581-8109)

NOTE:
PRIOR TO SCHEDULING OF THE PRE-CONSTRUCTION MEETING AND ISSUANCE OF THE WORK ORDER PERMIT, A BOND SHALL BE SUBMITTED BY THE PERMIT APPLICANT FOR THE VALUE OF THE SCOPE OF WORK TO BE PERFORMED AS ILLUSTRATED BY THE APPROVED WORK ORDER PLANS IN ACCORDANCE WITH T.M.C. 10.22.070, SECTION F.

GENERAL CONSTRUCTION SEQUENCE:

- ARRANGE NECESSARY PRE-CONSTRUCTION MEETINGS WITH THE CITY OF TACOMA CONSTRUCTION DIVISION AND BUILDING AND LAND USE SERVICE, TACOMA POWER, TACOMA WATER, ARCHITECT, AND ENGINEER.
- STAKE PROJECT LIMITS PRIOR TO BEGINNING CONSTRUCTION.
- NOTIFY CITY INSPECTOR IN WRITING ABOUT SCHEDULED UTILITY AND ROAD CLOSURES AT LEAST 14 DAYS PRIOR TO CONSTRUCTION.
- DAMAGE TO ANY OF THE PUBLIC UTILITIES AS A RESULT OF THE CONSTRUCTION OF THIS PROJECT SHALL BE REPAIRED BY THE CONTRACTOR.
- INSTALL ALL APPLICABLE TESC FACILITIES PER PLANS. MAINTAIN ALL TESC FACILITIES DURING THE LENGTH OF THE CONSTRUCTION PROCESS. ADDITIONAL FACILITIES MAY BE REQUIRED AS FIELD CONDITIONS WARRANT.
- DEMOLISH RAILWAY TRACK AND TIES PER APPROVED PLANS. COORDINATE UTILITY DISRUPTIONS WITH UTILITY PROVIDERS AND ADJACENT PROPERTY OWNERS AT LEAST 10 DAYS PRIOR TO CONSTRUCTION.
- INSTALL ALL NEW RAILWAY TRACK AND TIES.
- REMOVE TESC FACILITIES ONLY AFTER OBTAINING FINAL APPROVAL FROM CITY INSPECTOR.
- TRAFFIC TO REMAIN OPEN ON PORT OF TACOMA ROAD DURING CONSTRUCTION.

ELEVATION DATUM

VERTICAL DATUM: CITY OF TACOMA (NGVD 29)
BENCHMARK: 3 INCH BRASS DISK ON MILWAUKEE WAY, SOUTH OF E. 11TH AVENUE.
BENCHMARK NO. 2863
ELEVATION = 12.117'

BASIS OF BEARING

BASIS OF BEARINGS FOR THIS SURVEY IS THE CITY OF TACOMA DATUM, NAD 83(91) WASHINGTON SOUTH ZONE (3602).

SHEET INDEX:

- COVER SHEET
- SURVEY
- DEMOLITION & TESC PLAN
- DEMOLITION & TESC DETAILS
- RAIL SITE PLAN
- RAIL DETAILS
- NO. 9 TURNOUT PLAN
- RAIL DETAILS
- WORK ORDER GENERAL NOTES

PROJECT CONTACT INFORMATION

UTILITY CONTACTS				
OWNER - PORT OF TACOMA	UTILITY	REGULATORY AGENCY	CONTACT	PHONE NUMBER
PEDRO REYES, PROJECT MANAGER EMAIL: preyes@portoftacoma.com	STORM WATER	CITY OF TACOMA	ENVIRONMENTAL SERVICES	(253) 591-5588
	SANITARY SEWER	CITY OF TACOMA	ENVIRONMENTAL SERVICES	(253) 591-5588
	POWER	TACOMA POWER	JOHN MARTINSEN	(253) 502-8659
ENGINEER - KPFF CONSULTING ENGINEERS STEVEN KINGSLEY, PROJECT MANAGER PHONE: (253) 396-0150 EMAIL: steve.kingsley@kpff.com	WATER	TACOMA WATER	KAREN GERKEN	(253) 502-8736
			GRANT WHITLEY	(253) 502-8746
			TERRY BRENTIN	(253) 502-6242
	GAS	PSE/PILCHUCK	JOY BATEMAN	(253) 597-5100
	TELEPHONE	QWEST	MARTIN MCELROY	(253) 845-4867
	CABLE	AT&T BROADBAND	CARL ANDERSON	(253) 591-5503
	FIRE PROTECTION	CITY OF TACOMA	LARRY CRISWELL	(253) 591-5787
	CONST.	CITY OF TACOMA		



2407 North 31st Street, Suite 100
Tacoma, Washington 98407
(253) 396-0150 Fax (253) 396-0162

CALL 48 HOURS
BEFORE YOU DIG
1-800-424-5555



NO

REVISION

DATE

APPD

FINAL
CONSTRUCTION
CHECKED

DATE

SCALE

AS NOTED

DESIGNED

RLO

CHECKED

SWK

DRAWN

NLM

FIELD BOOKS

DRAWING NAME



CITY OF TACOMA
DEPARTMENT OF PUBLIC WORKS

REPLACEMENT OF RAILWAY TRACK
AT BUBBLE TRACK 1
COVER SHEET

WO17-0050

SHEET NO.

SHEET 1 OF 9

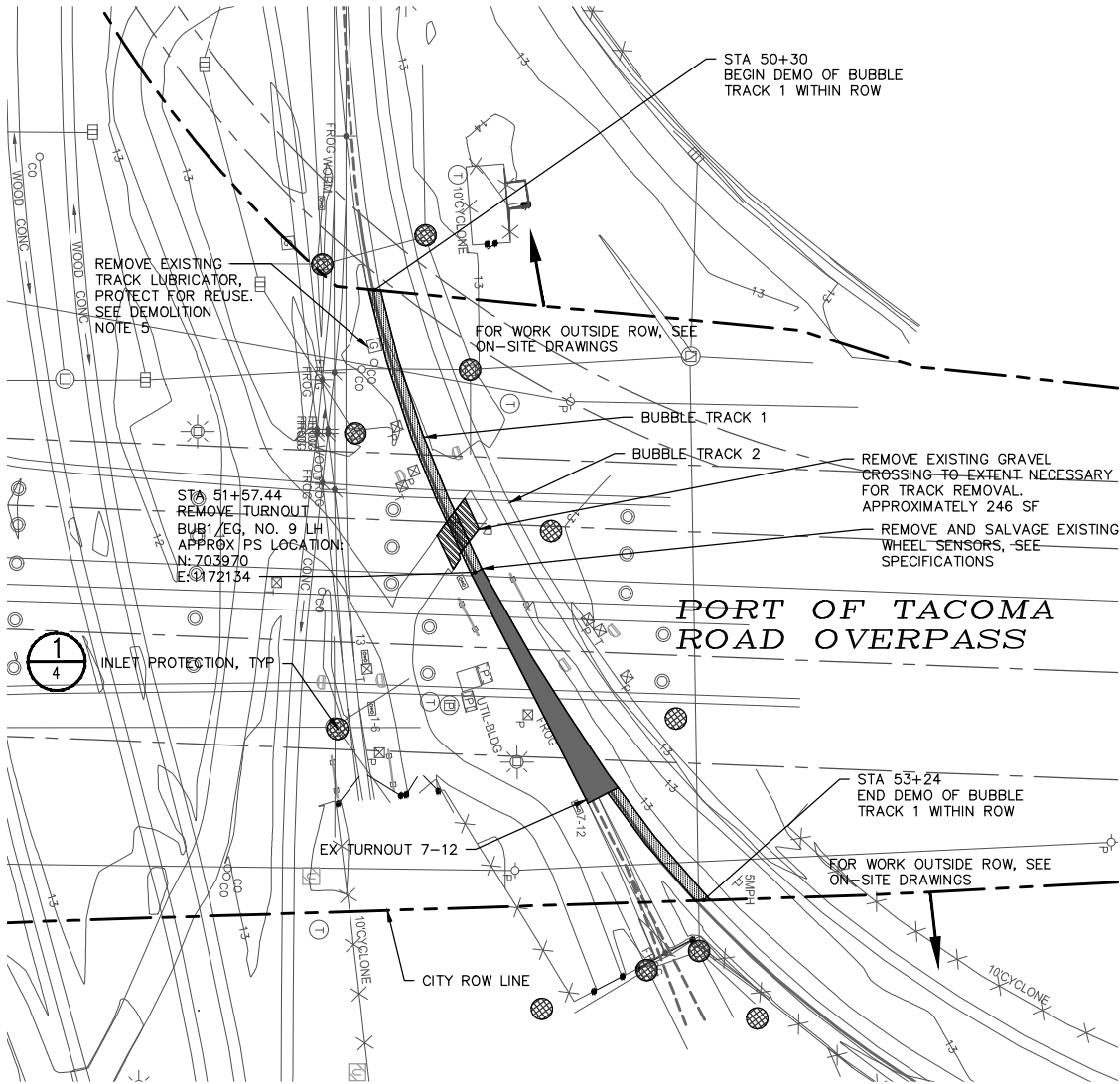

PLAN

SCALE: 1" = 40'

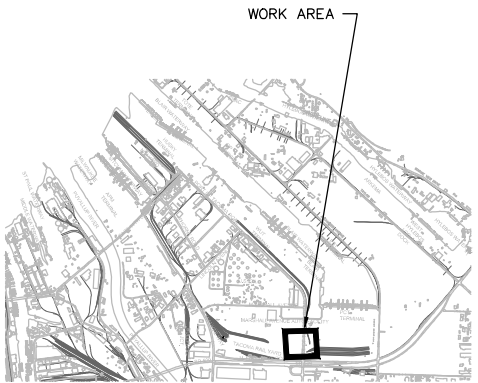



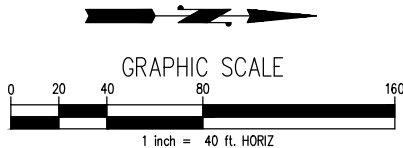

KEY PLAN

NTS

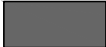

GRAPHIC SCALE

LEGEND

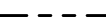
-  REMOVE RAILROAD TRACK
-  REMOVE NO. 9 TURNOUT
-  REMOVE GRAVEL GRADE CROSSING
-  CATCH BASIN INLET PROTECTION. CONTRACTOR TO INSURE ANY CATCH BASIN DOWNSTREAM OF THE PROJECT LIMITS (WITHIN 500') HAS INLET PROTECTION FOR THE DURATION OF CONSTRUCTION.
-  STRAW WATTLES, SEE EROSION AND SEDIMENT CONTROL NOTE 10
-  CITY ROW LINE

DEMOLITION NOTES:

- ALL LOCATIONS OF EXISTING IMPROVEMENTS AND UTILITIES SHOWN ARE FROM AVAILABLE GIS RECORDS AND FIELD SURVEY AND SHOULD BE CONSIDERED APPROXIMATE AND NOT NECESSARILY COMPLETE.
- CONTRACTOR SHALL COORDINATE ANY RELOCATION OF HYDRANTS AND ASSOCIATED WATER SERVICES WITH TACOMA WATER, INCLUDING PAYMENT OF ASSOCIATED FEES AND WORK COSTS, AND SCHEDULING OF WORK.
- CONTRACTOR SHALL MAINTAIN AND PROTECT ALL SITE IMPROVEMENTS NOT OTHERWISE NOTED FOR DEMOLITION. CONTRACTOR SHALL REPAIR OR REPLACE ALL ITEMS DAMAGED BY CONSTRUCTION AT NO ADDITIONAL COST TO THE OWNER.
- ALL START AND END REPLACEMENT TRACK LOCATIONS, WHICH MATCH INTO EXISTING TRACK ARE APPROXIMATE. THE CONTRACTOR SHALL FIELD LOCATE NEAREST EXISTING JOINT AT OR BEYOND MATCH POINT INDICATED, VERIFY VERTICAL AND HORIZONTAL ALIGNMENT AND TIE INTO EXISTING TRACK AT EXISTING JOINT.
- DISCONNECT EXISTING TRACK LUBRICATOR AT BUBBLE TRACK 1 PRIOR TO BUBBLE TRACK 1 DEMOLITION. EXISTING LUBRICATOR SHALL BE PROTECTED AND REINSTALLED AT EXISTING LOCATION PRIOR TO REOPENING OF TRACK. THE CONTRACTOR SHALL DOCUMENT THE CONDITION AND CONFIGURATION ON THE EXISTING LUBRICATOR AND REINSTALL TO MATCH. SEE SHEET 5 FOR SITE PLAN.
- ALL EXCAVATED SOIL AND BALLAST MATERIAL SHALL BE REUSED OR REMOVED PER THE CONTRACT SPECIFICATIONS.

EROSION & SEDIMENT CONTROL NOTES:

- APPROVAL OF THIS EROSION/SEDIMENTATION CONTROL (ESC) PLAN DOES NOT CONSTITUTE AN APPROVAL OF PERMANENT ROAD OR DRAINAGE DESIGN (E.G. SIZE AND LOCATION OF ROADS, PIPES, RESTRICTORS, CHANNELS, RETENTION FACILITIES, UTILITIES, ETC.).
- THE IMPLEMENTATION OF THESE ESC PLANS AND THE CONSTRUCTION, MAINTENANCE, REPLACEMENT AND UPGRADING OF THESE ESC FACILITIES IS THE RESPONSIBILITY OF THE APPLICANT/CONTRACTOR UNTIL ALL CONSTRUCTION IS COMPLETED AND APPROVED AND VEGETATION/LANDSCAPING IS ESTABLISHED.
- THE BOUNDARIES OF THE CLEARING LIMITS SHOWN ON THIS PLAN SHALL BE CLEARLY FLAGGED IN THE FIELD PRIOR TO CONSTRUCTION. DURING THE CONSTRUCTION PERIOD, NO DISTURBANCE BEYOND THE FLAGGED CLEARING LIMITS SHALL BE PERMITTED. THE FLAGGING SHALL BE MAINTAINED BY THE APPLICANT/CONTRACTOR FOR THE DURATION OF CONSTRUCTION.
- THE ESC FACILITIES SHOWN ON THIS PLAN MUST BE CONSTRUCTED IN CONJUNCTION WITH ALL CLEARING AND GRADING ACTIVITIES, AND IN SUCH A MANNER AS TO ENSURE THAT SEDIMENT AND SEDIMENT LADEN WATER DO NOT ENTER THE DRAINAGE SYSTEM OR ROADWAYS, OR VIOLATE APPLICABLE WATER STANDARDS.
- THE ESC FACILITIES SHOWN ON THIS PLAN ARE THE MINIMUM REQUIREMENTS FOR ANTICIPATED SITE CONDITIONS. DURING THE CONSTRUCTION PERIOD, THESE ESC FACILITIES SHALL BE UPGRADED AS NEEDED FOR UNEXPECTED STORM EVENTS AND TO ENSURE THAT SEDIMENT AND SEDIMENT-LADEN WATER DO NOT LEAVE THE SITE.
- THE ESC FACILITIES SHALL BE INSPECTED DAILY BY THE APPLICANT/CONTRACTOR AND MAINTAINED AS NECESSARY TO ENSURE THEIR CONTINUED FUNCTIONING.
- THE ESC FACILITIES ON INACTIVE SITES SHALL BE INSPECTED AND MAINTAINED A MINIMUM OF ONCE A MONTH OR WITHIN THE 48 HOURS FOLLOWING A STORM EVENT.
- ALL CATCH BASINS AND CONVEYANCE LINES SHALL BE CLEANED PRIOR TO PAVING. THE CLEANING OPERATION SHALL NOT FLUSH SEDIMENT-LADEN WATER INTO THE DOWNSTREAM SYSTEM.
- STABILIZED CONSTRUCTION ENTRANCES SHALL BE INSTALLED AT THE BEGINNING OF CONSTRUCTION AND MAINTAINED FOR THE DURATION OF THE PROJECT. ADDITIONAL MEASURES MAY BE REQUIRED TO ENSURE THAT ALL PAVED AREAS ARE KEPT CLEAN FOR THE DURATION OF THE PROJECT.
- IF SEDIMENT LADEN WATER IS OBSERVED LEAVING THE SITE, STRAW WATTLES SHALL BE INSTALLED AS NECESSARY TO MINIMIZE THE AMOUNT OF SEDIMENT LEAVING THE SITE THROUGH THE EXISTING STORMWATER COLLECTION AND CONVEYANCE SYSTEM.



2407 North 31st Street, Suite 100
Tacoma, Washington 98407
(253) 396-0150 Fax (253) 396-0162

CALL 48 HOURS
BEFORE YOU DIG
1-800-424-5555



NO

REVISION

DATE

APPD

FINAL
CONSTRUCTION
CHECKED

BY

DATE

FIELD BOOKS

DATE

DESIGNED

DRAWN

DRAWING NAME

SCALE

AS NOTED

CHECKED

PROJECT NAME



CITY OF TACOMA
DEPARTMENT OF PUBLIC WORKS

REPLACEMENT OF RAILWAY TRACK
AT BUBBLE TRACK 1
DEMOLITION & TESC PLAN

WO17-0050

SHEET NO.

SHEET 3 OF 9

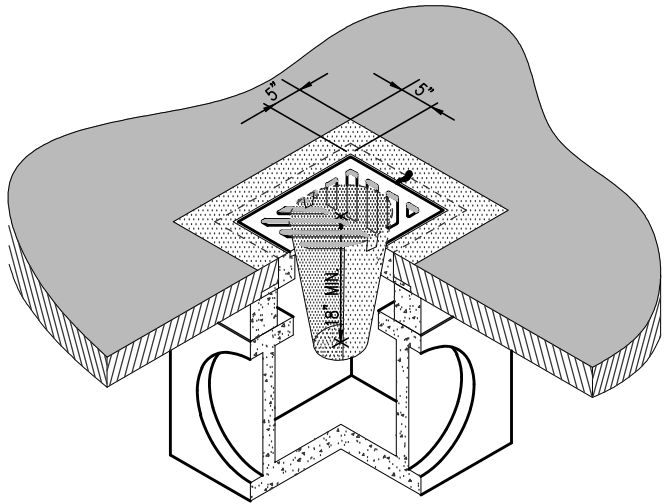

NOTES:

- 1. INSERT SHALL BE INSTALLED IN ALL OPERATIONAL CATCH BASINS WITHIN 500 FEET OF WORK LIMITS PRIOR TO CLEARING AND GRADING ACTIVITY, OR UPON PLACEMENT OF A NEW CATCH BASIN.
- 2. FILTERS SHALL BE INSPECTED AFTER EACH STORM EVENT AND CLEANED OR REPLACED WHEN IT IS 1/3 FULL.
- 3. SEDIMENT REMOVAL SHALL BE ACCOMPLISHED BY REMOVING THE INSERT, EMPTYING INTO APPROPRIATE DISPOSAL LOCATION, AND REINSERTING IT INTO THE CATCH BASIN.

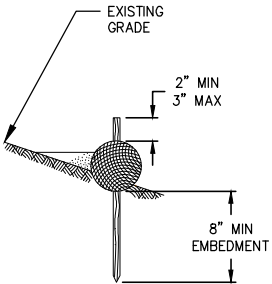

INLET PROTECTION DETAIL

SCALE: NTS

1
3

STRAW WATTLE DETAIL

SCALE: NTS

2
3



2407 North 31st Street, Suite 100
Tacoma, Washington 98407
(253) 396-0150 Fax (253) 396-0162

CALL 48 HOURS
BEFORE YOU DIG
1-800-424-5555



NO

REVISION

DATE

APPD

FINAL
CONSTRUCTION
CHECKED

BY

DATE

FIELD BOOKS

DATE

06/14/2017

DESIGNED

RLO

DRAWN

NLM

SCALE

AS NOTED

CHECKED

SWK

PROJECT NAME

DRAWING NAME



PLANNING & DEVELOPMENT SERVICES

CITY OF TACOMA
DEPARTMENT OF PUBLIC WORKS

REPLACEMENT OF RAILWAY TRACK
AT BUBBLE TRACK 1
DEMOLITION & TESC DETAILS

WO17-0050

SHEET NO.

SHEET 4 OF 9

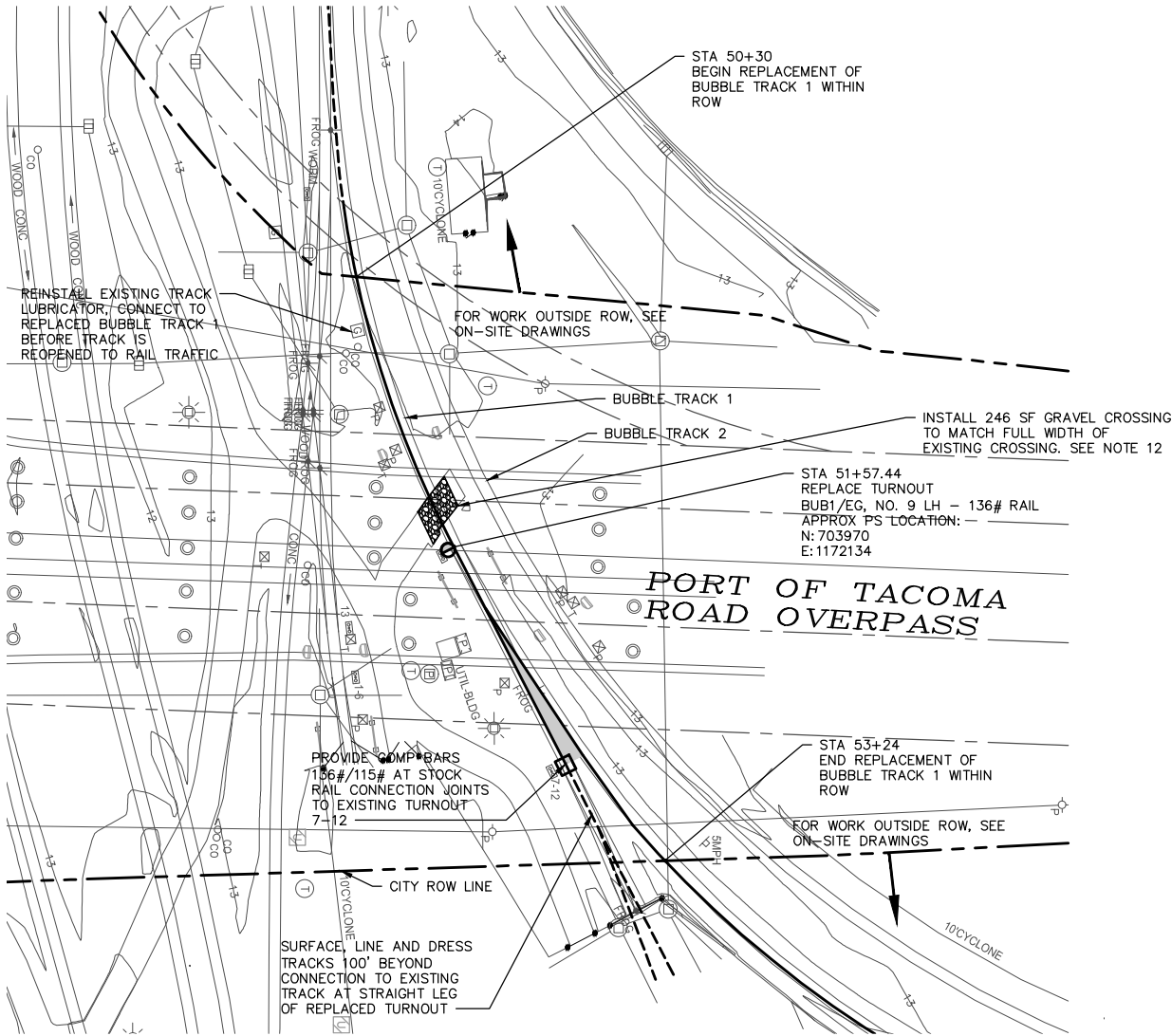

PLAN

SCALE: 1" = 40'

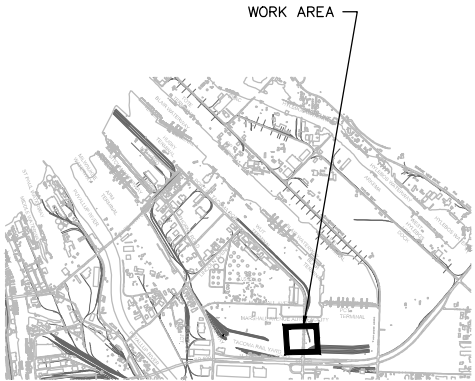

KEY PLAN

NTS

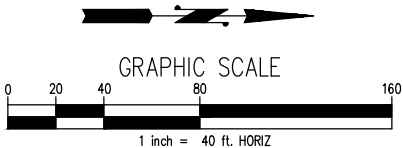

LEGEND

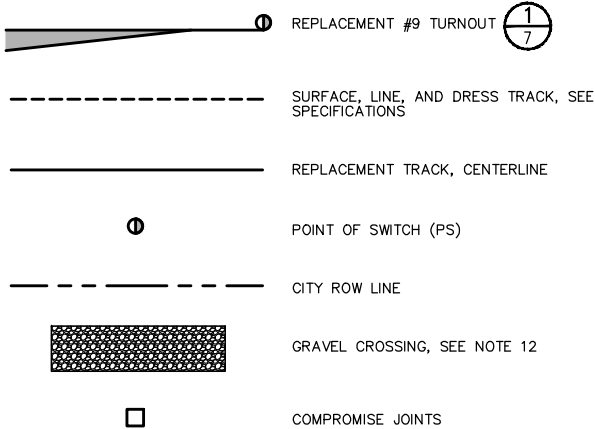

NOTES:

- SEE SHEETS 6-9 FOR TRACKWORK DETAILS.
- SEE SHEET 7 FOR SPECIAL TRACKWORK DETAILS AND VARIATIONS FROM PROJECT STANDARDS REQUIRED FOR TURNOUT REPLACEMENTS INCLUDING ADDITIONAL RAIL, TIES, COMPROMISE JOINTS NOT INDICATED IN PROJECT STANDARD TURNOUT CONFIGURATION.
- TURNOUT REPLACEMENTS ARE WITHIN ACTIVE TRACKS AND YARDS. CONTRACTOR SHALL CONFINE OPERATIONS AND STAGING TO THE LAYDOWN AREA PER ONSITE PLANS AND THE LIMITS OF THE TURNOUTS TO BE REPLACED. CONTRACTOR SHALL YIELD TO RAIL TRAFFIC AT ALL TIMES. SEE ON-SITE PLANS AND SPECIFICATIONS FOR ADDITIONAL PHASING AND SEQUENCING REQUIRED FOR THE PROJECT.
- NOT USED.
- CONTRACTOR SHALL DEMOLISH EXISTING TURNOUT AND CONNECTING TRACK TO EXTENT NECESSARY TO INSTALL NEW TURNOUT AND TRACK SHOWN, SEE SHEET 3.
- FOR TYPICAL BALLASTED TRACKBED SECTION, SEE (1/8 symbol)
- ALL NEW RAIL SHALL BE 136 LB JOINTED RAIL, EXCEPT WHERE NOTED.
- ALL NEW TRACK TIES ARE TIMBER, SEE SHEET 6 FOR STANDARD DETAILS.
- ALL START AND END REPLACEMENT TRACK LOCATIONS, WHICH MATCH INTO EXISTING TRACK, ARE APPROXIMATE. THE CONTRACTOR SHALL FIELD LOCATE NEAREST EXISTING JOINT AT OR BEYOND MATCH POINT INDICATED, VERIFY VERTICAL AND HORIZONTAL ALIGNMENT AND TIE INTO EXISTING TRACK AT EXISTING JOINT.
- ALL LOCATIONS OF EXISTING IMPROVEMENTS SHOWN ARE FROM AVAILABLE GIS RECORDS AND FIELD SURVEY AND SHOULD BE CONSIDERED APPROXIMATE AND NOT NECESSARILY COMPLETE.
- CONTRACTOR SHALL MAINTAIN AND PROTECT ALL SITE IMPROVEMENTS NOT OTHERWISE NOTED FOR DEMOLITION. CONTRACTOR SHALL REPAIR OR REPLACE ALL ITEMS DAMAGED BY CONSTRUCTION AT NO ADDITIONAL COST TO THE OWNER.
- GRAVEL CROSSING AT BUBBLE TRACK 1 SHALL BE COMPACTED CRUSHED SURFACING BASE COURSE. A LAYER OF GEOTEXTILE FABRIC SHALL BE PLACED OVER TRACKBED BALLAST AND FLUSH WITH TOP OF TIE; COVERING PLATES AND FASTENERS. CRUSHED SURFACING BASE COURSE SHALL BE PLACED TO 1" BELOW TOP OF RAIL FOR ENTIRE WIDTH OF CROSSING (MINIMUM 6" DEPTH), AND SHALL EXTEND 4' BEYOND END OF TIE OR TO ADJACENT TIE. FINISHED CROSSING SHALL RESULT IN NO VISIBLE MOVEMENT OF REPLACED RAIL WHEN CROSSING IS UTILIZED BY CONSTRUCTION EQUIPMENT AND TRAFFIC.



2407 North 31st Street, Suite 100
Tacoma, Washington 98407
(253) 396-0150 Fax (253) 396-0162

CALL 48 HOURS
BEFORE YOU DIG
1-800-424-5555



NO

REVISION

DATE

APPD

FINAL
CONSTRUCTION
CHECKED

BY

DATE

FIELD BOOKS

DATE

DESIGNED

DRAWN

DRAWING NAME

SCALE

CHECKED

PROJECT NAME



CITY OF TACOMA
DEPARTMENT OF PUBLIC WORKS

REPLACEMENT OF RAILWAY TRACK
AT BUBBLE TRACK 1
RAIL SITE PLAN

WO17-0050

SHEET NO.

SHEET

5

OF

9

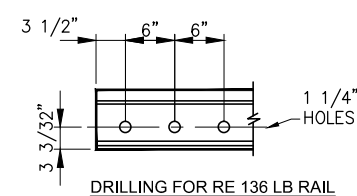
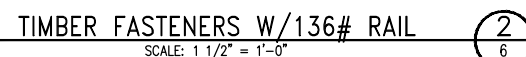
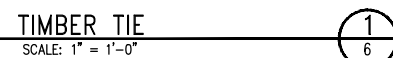

MOMENT OF INERTIA	94.20
SECTION MODULUS, HEAD	23.70
SECTION MODULUS, BASE	28.20
WEIGHT	135.8826 LBS PER YARD

DETAIL - RAIL
SECTION 136#

SCALE: 1" = 1'-0"

3
6

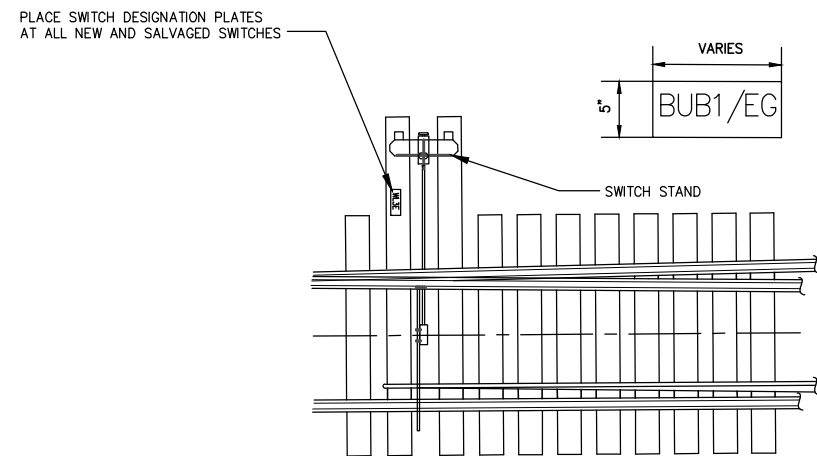
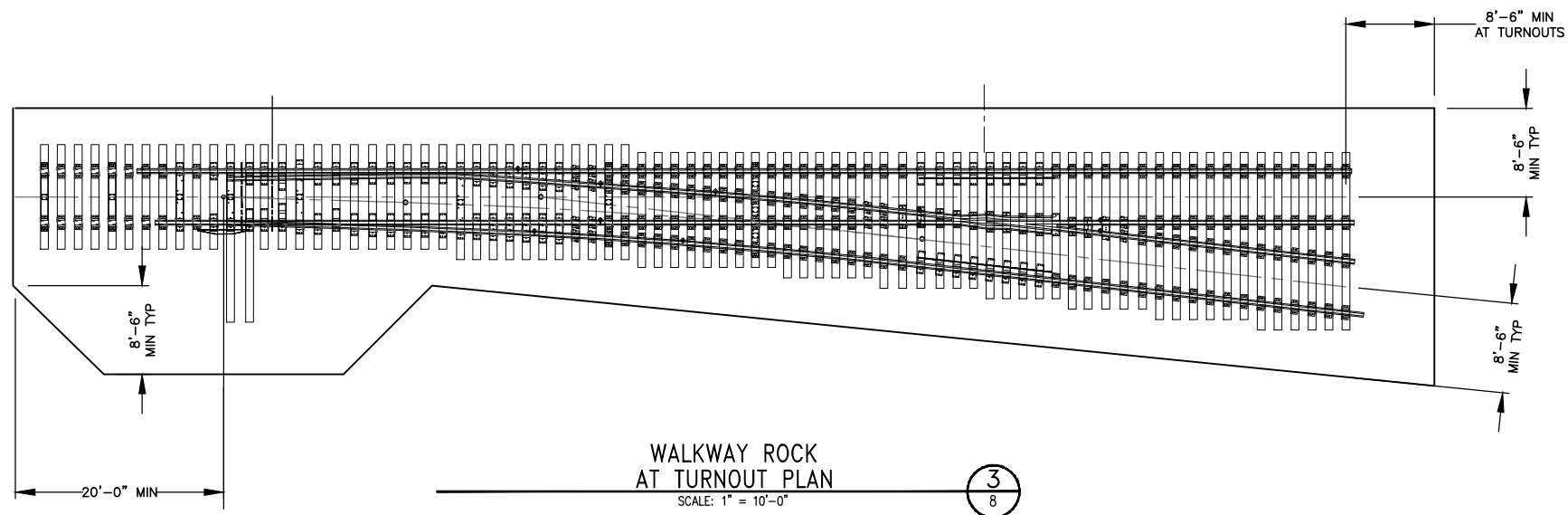
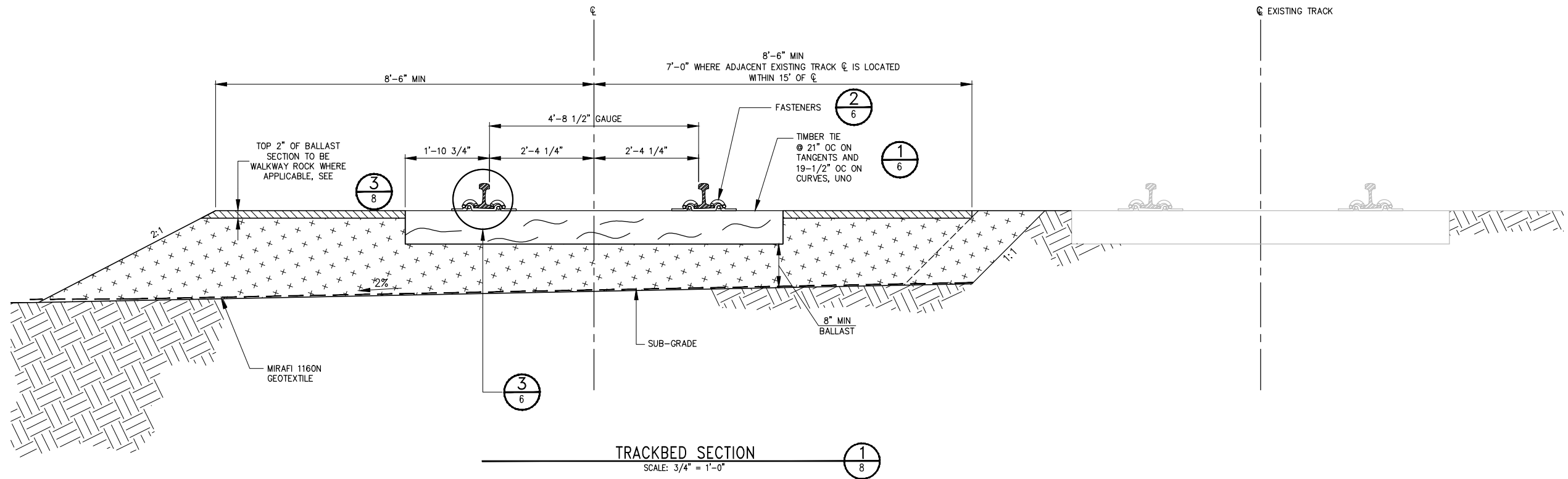

SWITCH DESIGNATION PLATE

SCALE: NTS

GENERAL

- A. The following special provisions are to be used in conjunction with the City of Tacoma Special Provisions, City of Tacoma Standard Plans and City of Tacoma Right-of-Way Design Manual, "2014 Standard Specifications for Road, Bridge and Municipal Construction" and "Standard Plans for Road, Bridge and Municipal Construction" as prepared by the Washington State Department of Transportation (WSDOT).
- B. Any inconsistency between these work order drawings and the 2014 Standard Specifications or the WSDOT Standard Plans shall be resolved by the following order of precedence (e.g., 1 prevailing over 2, 3, and so forth):
1. Approved Work Order Drawings
 2. City of Tacoma Special Provisions, Including APWA General Special Provisions, as applicable
 3. City of Tacoma Right-of-Way Design Manual
 4. 2014 Standard Specifications
 5. City of Tacoma Standard Plans
 6. WSDOT Standard Plans
- C. Any revisions to these plans must be reviewed and approved by the City of Tacoma prior to any implementation in the field.
- D. Contractors shall familiarize themselves with the site and shall bring any discrepancies to the attention of the Engineer prior to undertaking the affected work.
- E. Any discrepancy in these drawings, specifications, these notes, and the site conditions shall be reported to the Engineer, who shall correct such discrepancy in writing after reviewing any changes. Any work done by the Contractor after the discovery of such discrepancy shall be done at the Contractor's risk. The Contractor shall verify and coordinate the dimensions among all drawings prior to proceeding with any work.
- F. A pre-construction meeting shall be held at the City of Tacoma with the applicant, contractor, and City Inspectors prior to issuance of a permit.

ADDITIONAL PERMITS

- A. Separate permits are required for on-site work including all retaining walls, grading, and erosion control. Adherence to all conditions of these permits is required as a part of this plan.
- B. Separate permits are required for sidewalk installation as well as curb and gutter removal and driveway construction when constructed at building permit stage.
- C. Separate storm and sanitary sewer connection permits are required for connections to the wastewater or stormwater systems.

UTILITIES

- A. The existing underground utilities shown hereon are based upon existing record drawings and are not guaranteed to be accurate, nor all-inclusive.
- B. All utilities must be verified prior to construction. If the project requires any excavation, the developer/contractor is required to call the Utility Underground Location Center at (800) 424-5555 at least two days before starting such excavation in accordance with RCW 19.122.
- C. It shall be the Contractor's responsibility to protect, in place, all utilities and/or structures whether shown or not shown on this plan. Damage due to the Contractor's operations shall be repaired at the Contractor's expense.

EXCAVATION

- A. If workers enter any trench or other excavation four feet or more in depth that does not meet the open pit requirements of Section 2-09.3(3)B, it shall be shored and cribbed. All trench safety systems shall meet the requirements of the Washington Industrial Safety and Health Act, Chapter 49.17 RCW. The Contractor alone shall be responsible for all worker safety, and neither the City of Tacoma nor the Engineer of record assumes any responsibility.

PAVEMENT PREPARATION / RESTORATION

- A. Additional removal and replacement of pavement may be required to provide proper transition/crown as directed by the City of Tacoma Inspector in the field.
- B. The street sections shown on this plan are designed to be placed upon a firm and unyielding base.
- C. Subgrade compaction shall be tested by a professional geotechnical consultant prior to placing base material.
- D. Pavement restoration shall be constructed in accordance with the City of Tacoma Restoration policy and applicable Standard Plans.
- E. All permanent traffic channelization, such as but not limited to legends, raised pavement markings, paint, and signage, shall be restored to current Tacoma Standards.
- F. Final restoration limits shall be determined in the field by the City of Tacoma Inspector.
- G. Pavement Preparation and Restoration shall meet all applicable requirements of City of Tacoma Right-of-Way Design Manual Chapter 4 Sections 5.4 and 5.5.

PERMEABLE PAVEMENTS

- A. Permeable Pavements including pavers, porous asphalt and pervious concrete may be approved for use within the right of way.
- B. Installation shall be in accordance with the approved permit documents and all applicable requirements as outlined in the documents referenced in the GENERAL section above.
- C. Permeable pavers shall be designed and installed in accordance with manufacturer's recommendations, per approved permit drawings and the requirements of the City of Tacoma Right-of-Way Design Manual.
- HOT MIX ASPHALT**
- A. Standard hot mix asphalt shall be HMA CL 1/2 Inch PG 64-22.
- B. Porous asphalt shall be Class 2nd PG 70-22ER polymer modified or higher grade.
- C. Mix design shall be based on Standard Plan PD-01-Pavement Design Standards and PD-02 Pavement Design Worksheet.
- D. Section 5-04.3(9)A "Acceptance Sampling and Testing" of the Standard Specifications is deleted.
- E. All standard hot mix asphalt shall be compacted to a minimum of 92 percent of the maximum density as determined by AASHTO T209. All standard hot mix asphalt utilized shall be considered compactable. The level of compaction attained will be determined as the average of not less than 5 nuclear density gauge tests taken on the day the mix is placed (after completion of the finish rolling) at randomly selected locations within each lot. The quantity represented by each lot will be no greater than a single day's production or approximately 400 tons, whichever is less.
- F. All testing results shall be provided to the City within 48 hours of the test.
- G. Control lots not meeting the minimum density standard shall be removed and replaced with satisfactory material.
- H. In addition to the randomly selected locations for test of the control lot, the City Inspector reserves the right to test any area which appears defective and to require further compaction of areas that fail below acceptable density readings. These additional tests shall not impact the compaction evaluation of the entire control lot.
- I. Hot mix asphalt pavement shall not be placed on any traveled way between October 1 and April 1 without written approval from a Science & Engineering Assistant Division Manager.
- J. No traffic shall be allowed on any newly placed pavement without the approval of the City Inspector.

CONCRETE

- A. Concrete pavement mix design shall be based on Standard Plan PD-01-Pavement Design Standards.
- B. Cold Weather Concrete Work. The following requirements for placing concrete shall be in effect from November 1 to April 1:
1. The Engineer shall be notified at least 24 hours prior to any concrete placement.
 2. Weather permitting, all concrete placement shall be completed no later than 2:00 p.m. each day.
 3. Where forms have been placed and the subgrade has been subjected to severe frost, no concrete shall be placed until the ground is completely thawed. At that time, the forms shall be adjusted and subgrade repaired as determined by the Engineer.
- C. Curing of concrete shall be in accordance with Section 5-05.3(13) of the Standard Specifications.
- D. The slump for standard concrete used for sidewalks shall not exceed four inches +/- one inch.
- E. Sidewalks and curb ramps shall be constructed in accordance with ADA Standards for Accessible Design, 28 CFR, Part 35 and as supplemented by the Public Works Right of Way Accessibility Guidelines (PROWAG).

RIGHT-OF-WAY PERMITTING GENERAL NOTES

SANITARY AND STORM SEWERS

- A. 7-08.3(2)G Jointing of Dissimilar Pipe:
Dissimilar pipe shall be joined by use of rigid couplings manufactured by Romac Industries, Inc., or City of Tacoma approved equal.
- B. 7-08.3(2)F Plugs and Connections:
Rigid Couplings, manufactured by Romac Industries, Inc., or City of Tacoma approved equal, shall be used at any pipe joint in which bell and spigot or fused joints are not used. Flexible couplings are not permitted.
C. Section 7-04 of the Standard Specification is deleted. Storm sewers shall meet all the requirements of sanitary sewers.
- D. Sewers and appurtenances shall be cleaned and tested after backfilling by either exfiltration or low-pressure air method at the option of the Contractor, except where the ground water table is such that the Engineer may require the infiltration test.
- E. All wastewater and stormwater pipes shall be video inspected by City Forces prior to paving where paving occurs over sewers. All other sewers will be video inspected prior to final acceptance.
- F. All abandoned pipes encountered during construction and new stormwater and wastewater stub outs shall be sealed with a watertight pipe plug.
- G. All frames and grates for standard catch basin inlets on this project shall be "vaned" type and shall conform to that shown on WSDOT Standard Plan No. B-30.30-01 and B-30.40-01.
- H. Where existing catch basins are modified, grates may be required to be replaced with vaned grates. Environmental Services will make the final determination based on the condition of the existing grate and structure.
- I. Recycled concrete shall not be used for pipe zone backfill.
- J. New connections to brick manholes may be allowed on a case by case basis. Manhole replacement may be required by the Environmental Services Department based upon the condition of the existing manhole.

MISCELLANEOUS

- A. Any fence or structure replaced and/or relocated shall be maintained to remain functional.
- B. Independent quality assurance sampling and testing will be provided by a certified independent laboratory for all improvements within the right-of-way. All special inspection reports shall be forwarded to the Site Development Group on a monthly basis, and / or as requested by the City of Tacoma Inspector.
- C. The Contractor shall only use those hydrants designated by the agency in charge of water distribution and in strict accordance with its requirements for hydrant use. Water applied by the Contractor shall not be from residential sources.

GRADING, EXCAVATION, AND EROSION CONTROL NOTES

- A. All work is to be done in accordance with the approved grading plan, soils report, the most current WSDOT Standard Specifications For Road, Bridge And Municipal Construction and the current City of Tacoma Stormwater Management Manual.
- B. When construction operations are such that debris from the work is deposited on the streets, the Contractor shall immediately remove any deposits or debris which may accumulate on the roadway surface. If the Contractor fails to keep the streets free from deposits and debris resulting from the work, the Contractor shall, upon order of the City of Tacoma Inspector, provide facilities for, and remove all clay, dirt, or other deposits from the tires or between wheels before trucks or other equipment will be allowed to travel over paved streets. Should the Contractor fail or refuse to clean the streets in question, or the trucks or equipment in question, the City of Tacoma Inspector may order the work suspended at the Contractor's risk until compliance with the Contractor's obligations is assured, or the City of Tacoma Inspector may order the streets in question cleaned by others and such costs incurred by the City in achieving compliance with these requirements, including cleaning of the streets, shall be deducted from the work order account.
- C. The Contractor shall protect existing drainage structures using acceptable methods and materials as shown on this plan. If the methods and materials as shown on this plan are not adequate, the City of Tacoma Inspector may require additional/alternative methods for erosion control and/or protection of existing drainage structures. Additional or alternative methods shall be submitted by the design engineer and accepted by the City of Tacoma Inspector. Any damage caused to the City of Tacoma stormwater system as a result of the work outlined on this plan shall be the sole responsibility of the Contractor. Resolving said damage may include, but not be limited to, the cleaning of the drainage system in question by the Contractor.
- D. Watering provisions when applicable must be in place to prevent dust from becoming air borne. Violation of this condition will result in a stop work order until corrected.
- E. Fill that will support a street section or other structure shall be placed under the inspection of a Washington State licensed Geotechnical Engineer. Soil to be placed shall be tested and compacted to 95 percent of its maximum density. Engineer shall document existing site conditions, soil and its placement and allowable bearing capacity submitted. Standard requirements for cuts and fill are contained in the WSDOT Standard Specifications For Road, Bridges, and Municipal Construction.
- F. A stormwater pollution prevention plan (SWPPP) is required for all work order projects. The plan must be in accordance with the current City Tacoma Stormwater Management Manual.

HYDROSEEDING

- A. All areas that are cleared and grubbed, graded, excavated or filled are subject to stabilization. Any of these areas that are left unpaved or unlandscaped shall be hydroseeded or otherwise fully stabilized under the direction and approval of the Construction Inspector.
- B. Hydroseeding may occur only during the periods of April 1 through May 31 or September 1 through October 15. Hydroseeding may be allowed during the months of June through August if irrigation is provided.
- C. Monitor and maintain hydroseeded areas throughout the winter wet season to ensure that no erosion occurs.

EROSION CONTROL MEASURES

- A. Minimum Erosion Control measures shall include:
1. Construction entrance.
 2. Perimeter erosion/sedimentation control.
 3. Protection of catch basins.
 4. Stabilization of exposed soils.
- B. All erosion control shall be in place prior to clearing. The contractor shall call the City of Tacoma Inspector for initial erosion control inspection prior to start of work, per item F. below.
- C. Erosion control measures shall be maintained at all times to the approval of the City of Tacoma Inspector.
- D. Should temporary erosion and sedimentation control measures, as shown on plans become inadequate, the contractor shall install facilities as necessary to protect adjacent properties and the City of Tacoma drainage system, meeting approval of the City of Tacoma Inspector.
- E. No permits to perform grading, excavation, or filling during the period from October 1st through March 31 shall be issued. EXCEPTION: The City may approve a grading, excavation, or filling plan prepared by a licensed Civil or Geotechnical Engineer which specifically addresses the winter rain season and the associated erosion problems, and issue a permit based on such plan.
- F. Call for inspection of the City of Tacoma Inspector upon completion of:
1. Staking of clearing limits.
 2. Installation of erosion control and prior to site grading.
 3. Prior to removal of erosion control devices.
- G. All material removed from site shall be placed only at a permitted site. Verify location of destination of material prior to exportation.
- H. Traffic control provisions as approved by the City Traffic Engineer shall be adhered to at all times.
- I. Trees to be removed shall be clearly marked for removal. Trees to be saved shall be fenced with barricade fence at the drip line (outer edge of tree branches) to keep construction vehicles from compacting root zone and killing trees. This fencing shall be maintained until construction ends.
- J. Tree protection measures to be installed with initial TESC measures and shall be maintained throughout the duration of the site work. Refer to City of Tacoma Std. Plans LS-08 through LS-11.

RECORD DRAWINGS CRITERIA FOR ACCEPTANCE OF ALL PRIVATE WORK ORDERS

- A. All revisions to the approved plans must be approved by the City of Tacoma prior to implementation of the changes.
- B. A determination at the time of proposal shall be made whether the revision can be addressed with red line drawings submitted as a part of the record drawings or will require formal submission for approval.
- C. Record drawings shall show the station, offset, centerline and gutter flowline elevations, to nearest 0.01 foot, for all horizontal and vertical roadway alignment changes, at the intersection end of radius points and at the beginning and end of new paving.
- D. Record drawings shall show the station, offset, invert, and rim elevations to the nearest 0.01 foot for all stormwater and wastewater structures. (i.e.: manholes, catch basins, etc.)
- E. After any new stormwater and/or wastewater pipes have been cleaned and the manholes channeled, the main(s) shall be televised for video inspection to provide a record of the constructed conditions and for the wastewater system to verify side sewer connection locations. The City of Tacoma will coordinate this inspection.
- F. The property side ends of the side sewers shall be marked in the field by means of a 2-inch by 4-inch board and locate wire that extends from the flow line of the side sewer to at least 1 foot above the finished lot grade. Record drawings shall show all side sewers and shall locate them by measurements from permanent objects. (i.e.: curb, property corner, etc.) In addition, the depth of all side sewers shall be noted on the record drawings and locate board.
- G. Record drawings shall be received and accepted prior to issuing utility connection permits or release of performance bonds.
- H. Record drawings shall show vertical and horizontal datum for survey monuments (existing or new construction) within the limits of the project.
- I. Record drawings shall consist of a clean set of approved work order drawings with all changes noted above shown in red ink.
- J. Record drawings, including the Engineer's Certification, as applicable, must be submitted within 30 days of substantial completion or City survey crews will collect the necessary data and bill against the work order.

MONUMENT REMOVAL PERMIT PROCESS

"No survey monument shall be removed or destroyed (the physical disturbance or covering of a monument such that the survey point is no longer visible or readily accessible) before a permit is obtained from the Department of Natural Resources (DNR)." WAC 332-120-030(2) states "It shall be the responsibility of those performing construction work or other activity (including road and street resurfacing projects) to adequately search the records and the physical area of the proposed construction work or other activity for the purpose of locating and referencing any known or existing survey monuments." Construction shall not commence until WAC outlined in Chapter 332-120 is complied with.

STAKING REQUIREMENTS

WASTEWATER AND STORMWATER

- A. Clearing stakes if needed.
- B. Stakes every 50 feet plus grade breaks. Try to maintain 12 foot offsets in streets and 8 foot offsets in alleys.
- C. Double offsets at manholes and catch basins (ahead and back stakes at angle points).
- D. Catch basin station shall be to the centerline of the basin. Catch basin offsets shall be to the face of the curb.

RESIDENTIAL STREETS

- A. Clearing stakes as needed.
- B. Slope stakes every 50 feet and grade breaks if cuts or fills exceed 2 feet.
- C. Curb stakes every 50 feet and grade breaks, on 4 foot offset to the face of curb. Curb stakes are set to the top of curb grade (Blue Tape).
- D. Also stake the beginning and end of all approaches.
- E. No centerline of street grades unless the street grade is warped. If street grades are needed, set blue tops for each course.

ARTERIAL STREETS

- A. Clearing stakes as needed.
- B. Slope stakes every 50 feet and grade breaks if cuts or fills exceed 2 feet.
- C. Curb stakes every 50 feet and grade breaks, on 4 foot offset to the face of curb.
- D. Curb stakes are set to the top of curb grade (Blue Tape). Also stake the beginning and end of all approaches.
- E. Stake centerline and quarterline grade every 50 feet and grade breaks at grade for each course.

ALLEYS

- A. Stake both sides every 50 feet and grade breaks, on a 2 foot offset to the edge of paving, with a cut of fill to edge of paving on high side and flow line on low side.

SIDEWALKS

- A. Offsets for walks are set on 50' intervals and grade breaks normally at 2 foot to edge of walk and at edge of walk grade (Blue Tape).
- B. Sidewalk alignment is normally at 5 feet from the face of curb. No walk grades are needed if curbs are built.

HORIZONTAL AND VERTICAL CURVES

- A. Grade stakes must be set every 25 feet and grade breaks with a minimum of 3 stakes for each curve. Radius points on street Returns.

REVISED: 01-07-2016



2407 North 31st Street, Suite 100
Tacoma, Washington 98407
(253) 396-0150 Fax (253) 396-0162

CALL 48 HOURS
BEFORE YOU DIG
1-800-424-5555



NO

REVISION

DATE

APPD

FINAL CONSTRUCTION CHECKED	DATE 06/14/2017	SCALE AS NOTED
BY	DESIGNED RLO	CHECKED SWK
DATE	DRAWN NLM	PROJECT NAME
FIELD BOOKS	DRAWING NAME	

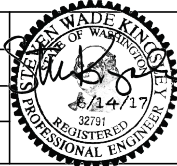

CITY OF TACOMA
DEPARTMENT OF PUBLIC WORKS

REPLACEMENT OF RAILWAY TRACK
AT BUBBLE TRACK 1
WORK ORDER GENERAL NOTES

WO17-0050

SHEET NO.

SHEET 9 OF 9

PORT OF TACOMA REPLACEMENT OF RAILWAY TRACK AT
LINCOLN AVE OVERPASS

1736 MILWAUKEE WAY
TACOMA, WASHINGTON

ABBREVIATIONS

BC	BOTTOM OF CURB
BW	BACK OF WALK
C&G	CURB & GUTTER
CB	CATCH BASIN
CL	CENTERLINE
CO	CLEANOUT
CONC	CONCRETE
CONST	CONSTRUCTION
DIA, Ø	DIAMETER
D/W	DUCTILE IRON PIPE
E	DRIVEWAY
EX/EXIST	EAST, EASTING
FF	EXISTING
FL	FINISH FLOOR
HP	FLOW LINE
IE	HIGH POINT
LF	INVERT ELEVATION
LT	LINEAR FOOT
LP	LEFT
MECH	MECHANICAL
MH	MANHOLE
N	NORTH, NORTHING
NTS	NOT TO SCALE
P	POWER
PC	POINT OF CURVATURE
PCC	POINT OF COMBINED CURVATURE
P, P/L	PROPERTY LINE
PRC	POINT OF REVERSED CURVATURE
PT	POINT OF TANGENCY
PVC	POLYVINYL CHLORIDE/POINT OF VERTICAL CURB
R	RADIUS
RT	RIGHT
RTO	RETURN TO OWNER
ROW	RIGHT-OF-WAY
S	SOUTH
SD	STORM DRAIN
SS	SANITARY SEWER
STA	STATION
S/W	SIDEWALK
T	TELEPHONE
TC	TOP OF CURB
TP	TYPICAL
U	UNDERGROUND
W	WATER/WEST
W/	WITH
Ø	AT

GENERAL PLAN NOTES

- COORDINATE ALL WORK WITH ON-SITE DOCUMENTS.
- THE CONTRACTOR SHALL BE RESPONSIBLE FOR PROVIDING ADEQUATE SAFEGUARDS, SAFETY DEVICES, PROTECTIVE EQUIPMENT, FLAGGERS AND ANY OTHER NEEDED ACTIONS TO PROTECT THE LIFE, HEALTH AND SAFETY OF THE PUBLIC. ANY WORK WITHIN THE TRAVELED RIGHT-OF-WAY THAT MAY INTERRUPT NORMAL TRAFFIC FLOW SHALL REQUIRE NOTIFICATION AND COORDINATION WITH THE CITY OF TACOMA.
- ALL MATERIALS AND CONSTRUCTION SHALL BE IN ACCORDANCE WITH THE 2010 WASHINGTON STATE DEPARTMENT OF TRANSPORTATION (WSDOT) STANDARD SPECIFICATIONS FOR ROAD, BRIDGE AND MUNICIPAL CONSTRUCTION AS MODIFIED FOR USE BY THE CITY OF TACOMA AND THE CITY OF TACOMA STANDARD PLANS. A COPY OF THE APPROVED PLANS AND SPECIFICATIONS SHALL BE ON-SITE WHENEVER CONSTRUCTION IS IN PROGRESS.
- PRIOR TO CONSTRUCTION, THE CONTRACTOR SHALL OBTAIN ALL PERMITS REQUIRED FOR WORK WITHIN THE PUBLIC RIGHT-OF-WAY.
- ALL LOCATIONS OF EXISTING UTILITIES SHOWN HEREON HAVE BEEN ESTABLISHED BY FIELD SURVEY OR OBTAINED FROM AVAILABLE RECORDS AND SHOULD THEREFORE BE CONSIDERED APPROXIMATE ONLY AND NOT NECESSARILY COMPLETE. IT IS THE SOLE RESPONSIBILITY OF THE CONTRACTOR TO INDEPENDENTLY VERIFY THE ACCURACY OF ALL UTILITY LOCATIONS SHOWN AND TO FURTHER DISCOVER AND AVOID ANY OTHER UTILITIES NOT SHOWN HEREON WHICH MAY BE AFFECTED BY THE IMPLEMENTATION OF THIS PLAN.
- THE CONTRACTOR SHALL VERIFY THE LOCATIONS OF UTILITIES BY CONTACTING A UTILITY LOCATE SERVICE AND SHALL PROVIDE SUFFICIENT NOTIFICATION TO THE AFFECTED UTILITY COMPANIES PRIOR TO STARTING WORK. COORDINATE WORK FOR EXISTING UTILITIES WITH CONTACTS SHOWN IN THE UTILITY CONTACTS TABLE. CONTACT UNDERGROUND UTILITIES LOCATION AT 1-800-424-5555 AT LEAST 48 HOURS BEFORE COMMENCEMENT OF CONSTRUCTION.
- THE CONTRACTOR SHALL NOTIFY THE TACOMA FIRE DEPARTMENT (253) 591-5737 24 HOURS IN ADVANCE OF ALL WATER SERVICE INTERRUPTIONS, HYDRANT SHUTOFFS, AND STREET CLOSURES OR OTHER ACCESS BLOCKAGE. THE CONTRACTOR SHALL ALSO NOTIFY THE FIRE DEPARTMENT OF ALL NEW, RELOCATED, OR ELIMINATED HYDRANTS RESULTING FROM THIS WORK.
- THE CONTRACTOR SHALL MAINTAIN EMERGENCY VEHICLE ACCESS ON ALL AFFECTED STREETS AT ALL TIMES.
- MAINTAIN AND PROTECT ALL MANHOLES, CATCH BASINS, FIRE HYDRANTS, MONITORING WELLS, WATER VALVES, PIPING, SURVEY MONUMENTS, TRAFFIC CONTROL BOXES, WATER METERS AND ENGINEER OTHER IMPROVEMENTS UNLESS OTHERWISE NOTED ON THE PLANS. CONTRACTOR SHALL REPAIR OR REPLACE ALL ITEMS DAMAGED BY THE CONSTRUCTION OPERATIONS AT NO ADDITIONAL COST TO THE OWNER.
- THESE PLANS ARE APPROVED FOR CONSTRUCTION FOR A PERIOD OF 24 MONTHS FROM THE DATE OF CITY APPROVAL. THE CITY RESERVES THE RIGHT TO REQUIRE REVISIONS, ADDITIONS, DELETIONS, OR MODIFICATIONS SHOULD CONSTRUCTION BE DELAYED BEYOND THIS TIME LIMITATION OR IF FIELD CONDITIONS ARE DIFFERENT FROM WHAT IS DEPICTED ON THESE PLANS.
- THE CONTRACTOR IS RESPONSIBLE FOR PROVIDING A TRAFFIC CONTROL PLAN TO THE CITY THAT MEETS THE CRITERIA OF THE CITY OF TACOMA TRAFFIC CONTROL HANDBOOK AND RIGHT-OF-WAY DESIGN MANUAL. CONTACT PUBLIC WORKS TRAFFIC ENGINEER, PHONE # (253) 591-5554 FOR SPECIFIC TRAFFIC CONTROL REQUIREMENTS FOR THIS PROJECT. A TRAFFIC CONTROL PLAN SHALL BE SUBMITTED AND APPROVED PRIOR TO COMMENCING WORK.
- CONTRACTOR SHALL VERIFY ALL UTILITY POINTS OF CONNECTIONS TO EXISTING UTILITIES PRIOR TO CONSTRUCTION AND NOTIFY ENGINEER OF ANY DISCREPANCY.
- EXCAVATED MATERIAL MEETING PROJECT SPECIFICATIONS MAY BE USED FOR BACKFILL. NO STOCKPILING OF EXCAVATED MATERIAL IS ALLOWED WITHIN THE PROJECT LIMITS.
- REMOVE AND REPLACE ALL BROKEN, DAMAGED, OR HAZARDOUS SIDEWALK, CURB AND GUTTER, AND DRIVEWAYS.
- RESTORATION SHALL BE IN ACCORDANCE WITH THE CITY OF TACOMA ROW RESTORATION POLICY AS ADOPTED JUNE 2, 2009.
- THE ENGINEER OF RECORD SHALL PROVIDE AN ENGINEER'S CERTIFICATION TO THE CITY OF TACOMA AFTER FACILITY INSTALLATION AND PRIOR TO PERMIT FINAL INSPECTION AND/OR CLOSEOUT. THE ENGINEER'S CERTIFICATION SHALL INCLUDE:
 - THE PERMIT NUMBER
 - STATEMENTS TO ATTEST:
 - THAT ALL STORMWATER FACILITIES HAVE BEEN INSTALLED ACCORDING TO THE APPROVED PERMIT DOCUMENTS. CHANGES TO THE APPROVED PERMIT SET THAT ARE REQUIRED DURING CONSTRUCTION SHALL BE SUBMITTED TO BLUS FOR ESSE TO REVIEW AND APPROVAL DURING THE CONSTRUCTION PHASE AND PRIOR TO THE CHANGE BEING CONSTRUCTED.
 - AS-BUILT DRAWINGS HAVE BEEN PROVIDED TO THE CITY ELECTRONICALLY. THESE SHALL BE PROFESSIONALLY DRAFTED ENGINEERING DRAWINGS THAT ARE STAMPED, SIGNED, AND DATED BY A WASHINGTON STATE LICENSED ENGINEER. THE DRAWINGS MUST ACCURATELY REPRESENT THE PROJECT AS CONSTRUCTED.
 - THE OPERATIONS AND MAINTENANCE MANUAL IS LOCATED ONSITE.

THE ENGINEER'S CERTIFICATION SHALL BE SUBMITTED TO ENVIRONMENTAL SERVICES / PLAN REVIEW LEAD / 326 EAST D STREET / TACOMA, WA 98421. FOR SITE AND BUILDING PERMITS SEND A COPY OF THE CERTIFICATION TO BUILDING AND LAND USE SERVICES 747 MARKET STREET, ROOM 345, TACOMA, WA 98402.

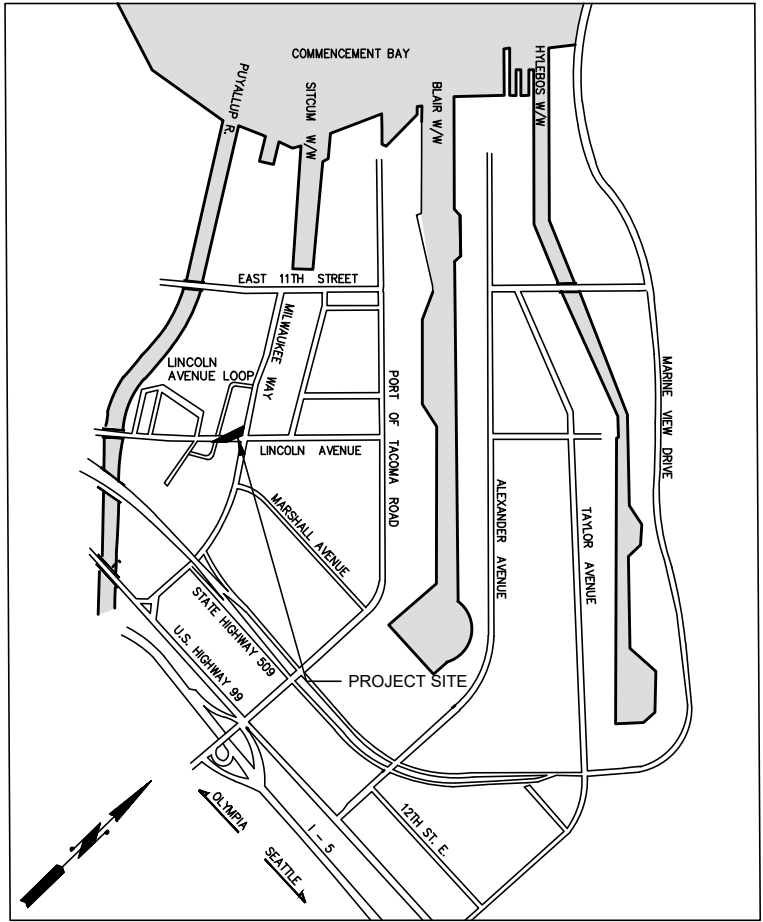

VICINITY MAP
NTS

TRAFFIC CONTROL NOTES

LOCATION: UNDERNEATH LINCOLN AVENUE OVERPASS, ADJACENT TO MILWAUKEE WAY
THE FOLLOWING SPECIAL TRAFFIC CONTROLS SHALL SUPPLEMENT SECTION 1-07.23 OF THE STANDARD SPECIFICATIONS.

- BIDIRECTIONAL TRAFFIC TO BE MAINTAINED ON LINCOLN AVE LOOP AND MILWAUKEE WAY THROUGHOUT THE DURATION OF PROJECT. THE IMPACTED PORTION OF LINCOLN AVE (BELOW THE OVERPASS) IS CLOSED TO PUBLIC TRAFFIC AND IS ANTICIPATED TO REMAIN SO THROUGHOUT CONSTRUCTION. THE CONTRACTOR IS RESPONSIBLE FOR PROVIDING A TRAFFIC CONTROL PLAN TO THE CITY THAT MEETS THE CITY OF TACOMA TRAFFIC CONTROL HANDBOOK AND RIGHT-OF-WAY DESIGN MANUAL. CONTACT TRAFFIC DEPARTMENT, PHONE NUMBER (253) 591-5554, FOR SPECIFIC TRAFFIC CONTROL REQUIREMENTS FOR THIS PROJECT. A TRAFFIC CONTROL PLAN SHALL BE SUBMITTED AND APPROVED PRIOR TO COMMENCING WORK.
- WHEN NECESSARY, AND JUSTIFIED, SINGLE LANES OF TRAFFIC MAY BE CLOSED DURING SPECIFIED HOURS OF THE DAY. THE DETERMINATION OF THESE HOURS SHALL BE IN CONSULTATION WITH AND SUBJECT TO THE APPROVAL OF THE CITY TRAFFIC ENGINEER AND PORT OF TACOMA. PROVIDED THAT LOCAL ACCESS IS MAINTAINED AT ALL TIMES WITH A MINIMUM OF A 12-FOOT WIDE ACCESS LANE FOR EACH DIRECTION OF TRAFFIC. THE CONTRACTOR SHALL COORDINATE ANY LANE CLOSURES AND COOPERATE WITH THE VARIOUS BUSINESSES AND/OR RESIDENCES ADJACENT TO THE PROJECT SITE. A MINIMUM OF ONE ACCESS SHALL BE MAINTAINED TO ALL PROPERTIES AND DRIVEWAYS ON LINCOLN AVE LOOP AND MILWAUKEE WAY AT ALL TIMES.

THREE (3) WORKING DAYS PRIOR TO ANY LANE CLOSURE, THE CONTRACTOR SHALL NOTIFY:

TACOMA PUBLIC WORKS ENGINEERING DIVISION	(253-591-5500)
TACOMA PUBLIC WORKS STREETS AND GROUNDS	(253-591-5495)
TACOMA PUBLIC WORKS SOLID WASTE	(253-591-5544)
TACOMA FIRE DEPARTMENT	(253-591-5733)
TACOMA POLICE DEPARTMENT	(253-591-5951)
LESA COMMUNICATION CENTER	(253-798-4721-Opt.#3)
TACOMA PUBLIC SCHOOLS TRANSPORTATION OFFICE	(253-571-1853)
PIERCE TRANSIT	(253-581-8109)

GENERAL NOTES:

- PRIOR TO SCHEDULING OF THE PRE-CONSTRUCTION MEETING AND ISSUANCE OF THE WORK ORDER PERMIT, A BOND SHALL BE SUBMITTED BY THE PERMIT APPLICANT FOR THE VALUE OF THE SCOPE OF WORK TO BE PERFORMED AS ILLUSTRATED BY THE APPROVED WORK ORDER PLANS IN ACCORDANCE WITH T.M.C. 10.22.070, SECTION F.

GENERAL CONSTRUCTION SEQUENCE:

- ARRANGE NECESSARY PRE-CONSTRUCTION MEETINGS WITH THE CITY OF TACOMA CONSTRUCTION DIVISION AND BUILDING AND LAND USE SERVICE, TACOMA POWER, TACOMA WATER, ARCHITECT, AND ENGINEER.
- STAKE PROJECT LIMITS PRIOR TO BEGINNING CONSTRUCTION.
- NOTIFY CITY INSPECTOR IN WRITING ABOUT SCHEDULED UTILITY AND ROAD CLOSURES AT LEAST 14 DAYS PRIOR TO CONSTRUCTION.
- DAMAGE TO ANY OF THE PUBLIC UTILITIES AS A RESULT OF THE CONSTRUCTION OF THIS PROJECT SHALL BE REPAIRED BY THE CONTRACTOR.
- INSTALL ALL APPLICABLE TESC FACILITIES PER PLAN. MAINTAIN ALL TESC FACILITIES DURING THE LENGTH OF THE CONSTRUCTION PROCESS. ADDITIONAL FACILITIES MAY BE REQUIRED AS FIELD CONDITIONS WARRANT.
- DEMOLISH PAVEMENT, RAILWAY TRACK AND TIES PER APPROVED PLANS. COORDINATE UTILITY DISRUPTIONS WITH UTILITY PROVIDERS AND ADJACENT PROPERTY OWNERS AT LEAST 10 DAYS PRIOR TO CONSTRUCTION.
- INSTALL ALL NEW PAVEMENT, RAILWAY TRACK AND TIES AND CHANNELIZATION.
- REMOVE TESC FACILITIES ONLY AFTER OBTAINING FINAL APPROVAL FROM CITY INSPECTOR.
- TRAFFIC TO REMAIN OPEN ON LINCOLN AVE LOOP AND MILWAUKEE WAY DURING CONSTRUCTION.

ELEVATION DATUM

VERTICAL DATUM: CITY OF TACOMA (NGVD 29)
BENCHMARK: 3 INCH BRASS DISK ON MILWAUKEE WAY, SOUTH OF E. 11TH AVENUE.
BENCHMARK NO. 2863
ELEVATION = 12.117'

BASIS OF BEARING

BASIS OF BEARINGS FOR THIS SURVEY IS THE CITY OF TACOMA DATUM, NAD 83(91) WASHINGTON SOUTH ZONE (3602).

PROJECT CONTACT INFORMATION

UTILITY CONTACTS				
OWNER - PORT OF TACOMA	UTILITY	REGULATORY AGENCY	CONTACT	PHONE NUMBER
PEDRO REYES, PROJECT MANAGER EMAIL: preyes@portoftacoma.com	STORM WATER	CITY OF TACOMA	ENVIRONMENTAL SERVICES	(253) 591-5588
	SANITARY SEWER	CITY OF TACOMA	ENVIRONMENTAL SERVICES	(253) 591-5588
	POWER	TACOMA POWER	JOHN MARTINSEN	(253) 502-8659
	WATER	TACOMA WATER	KAREN GERKEN	(253) 502-8736
ENGINEER - KPFF CONSULTING ENGINEERS STEVEN KINGSLEY, PROJECT MANAGER PHONE: (253) 396-0150 EMAIL: steve.kingsley@kpff.com	GAS	PSE/PILCHUCK	GRANT WHITLEY	(253) 502-8746
	TELEPHONE	QWEST	TERRY BRENTIN	(253) 502-6242
	CABLE	AT&T BROADBAND	JOY BATEMAN	(253) 597-5100
	FIRE PROTECTION	CITY OF TACOMA	MARTIN MCELROY	(253) 845-4867
	CONST.	CITY OF TACOMA	CARL ANDERSON	(253) 591-5503
			LARRY CRISWELL	(253) 591-5787



2407 North 31st Street, Suite 100
Tacoma, Washington 98407
(253) 396-0150 Fax (253) 396-0162

CALL 48 HOURS
BEFORE YOU DIG
1-800-424-5555



NO

REVISION

DATE

APPD

FINAL CONSTRUCTION CHECKED	DATE 06/14/2017	SCALE AS NOTED
BY	DESIGNED RLO	CHECKED SWK
DATE	DRAWN NLN	PROJECT NAME
FIELD BOOKS	DRAWING NAME	

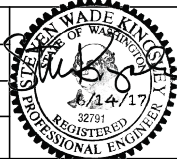

CITY OF TACOMA
DEPARTMENT OF PUBLIC WORKS

REPLACEMENT OF RAILWAY TRACK
UNDER LINCOLN AVE OVERPASS
COVER SHEET

WO17-0051

SHEET NO.

SHEET 1 OF 10