



QUESTIONS & RESPONSES #02

RFQ TITLE 071645 | FABULICH CENTER BUILDING ENVELOPE RESTORATION

CONTACT Kathee Sewell, Sr. Contract Analyst

EMAIL procurement@portoftacoma.com

PHONE NUMBER 253.888.4711

SUBMITTAL DUE DATE 5/12/2022

Q&A ISSUE DATE 5/16/2022 @ 4:00 PM (PST)

PROPOSER QUESTIONS	PORT RESPONSES	RFQ Section
A reference was made a the walk through that electrical work would be needed for the security system. I am unable to locate info on the plans. Please clarify the extent of the electrical work.	See sheet D1.01 note B on typical preparation key notes and Section 01 14 00 Work Restrictions	D1.01
Is the building going to be painted upon completion of the work?	The specifications and drawings note that a new coating shall be applied to all stucco and concrete surfaces.	Specifications & Drawings
Are there General Contractors bidding?	We won't know who is bidding until time of bid opening.	General
Can we bid the caulking scope only?	You must bid on the entire project or you will be found non responsive.	General
Is it necessary to Remove then reinstall the signage plus other surface mounted items?	Please see Section 01 14 00 – Work Restrictions and Plan Sheet D1.01 for scope of signage and surface mounted items.	D1.01
The detail of the fillet joint where the sill/header meets the window system is misleading. One detail 7/W3.01 shows it very simply as a fillet, probably standard. Whereas 3/W3.02 indicates it should be installed per 9A/W3.01 which is like a massive cove joint more in line with a wet seal application.	“Bond break tape is not needed at the small sealant fillet as noted on repair keynote 1, delete this scope. Add the fillet sealant/band aid over receiver” scope to detail 10 on W3.01 to match detail 7 on sheet W3.01.” The small fillet sealant/ band aid is not need at detail 3 because it has overhead protection. See diagram on page 2.	W3.01
The fillet joint where the sill/header can meets the window system is only shown as being addressed where there is plaster below at the sill location (Detail 7). It is not shown being addressed at the Head (Detail 3) or Sill at concrete base (Detail 10). Since it's a small item I'd prefer to get everyone bidding it the same way.	“Bond break tape is not needed at the small sealant fillet as noted on repair keynote 1, delete this scope. Add the fillet sealant/band aid over receiver” scope to detail 10 on W3.01 to match detail 7 on sheet W3.01.” The small fillet sealant/ band aid is not need at detail 3 because it has overhead protection. See diagram on page 2.	W3.01
They are not addressing anything at the stucco reveal joints. Is this included?	Coating over stucco reveals is acceptable.	
Are there any tie off points on the roof, and if so do they have the proper inspections up to date?	No tie off points are located on the roof.	
Per D1.01 in the preparation notes G. Is there an assumed quantity of cracks in the stucco and concrete that need to be routed and sealed?	Assume 300, if it is worse on west elevation in CIP.	D1.01
Please se the attachment. Is this detail for the fabric highlighted in red correct? The black and white pictures make the detail look a little convoluted.	The reinforcing fabric is to be horizontal only, delete the vertical leg at all conditions. See diagram on page 3.	
Is there an assumed allowance for the roof flashing in case some gets bent or deemed unusable. It is really hard to tell how this is fastened, and if set in sealant can get twisted very easily.	It is assumed that it will remain and be coated under the drip edge and cleat.	
Is there adequate power to run multiple swing stages? Will the owner provide power if not.	Please see Section 01 50 00 – Temporary Facilities and Controls 1.02 A & B	Section 01 50 00
Is there an assumed start date and completion date?	After bid opening it is anticipated that a contract award will be within 30 days. Once the contract is awarded the low responsive responsible bidder will have 120 days for substantial completion.	

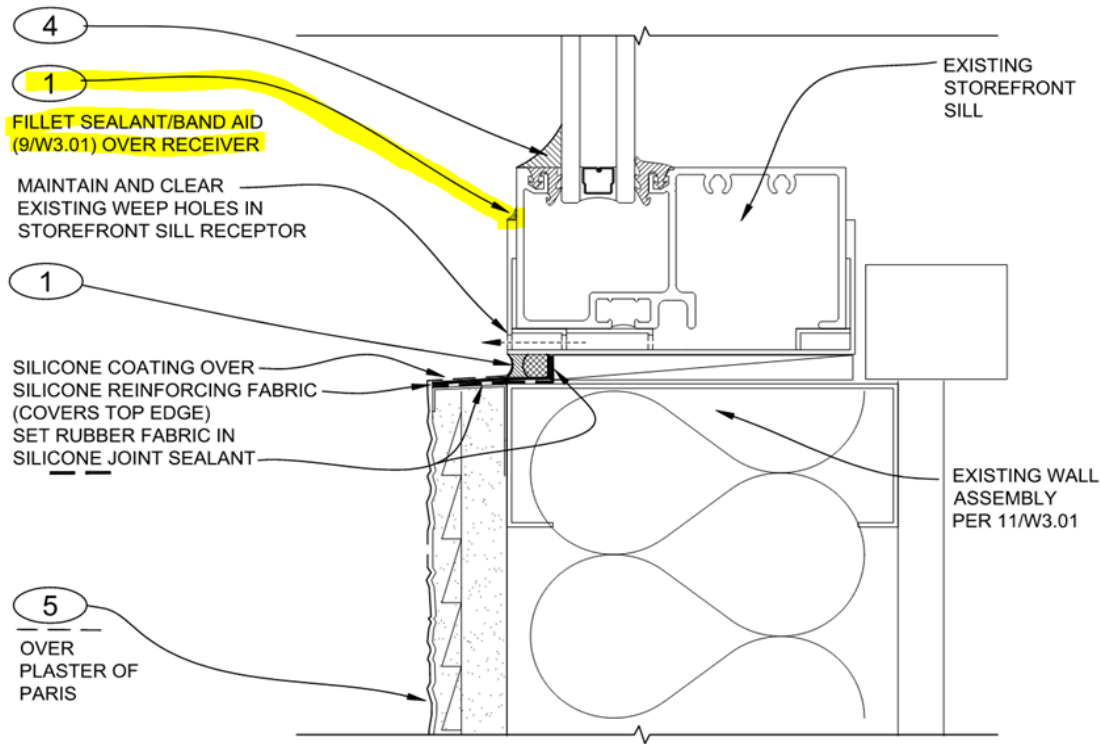

7 STOREFRONT SILL AT PLASTER

W3.01 SCALE: 6"=12" (do not scale)

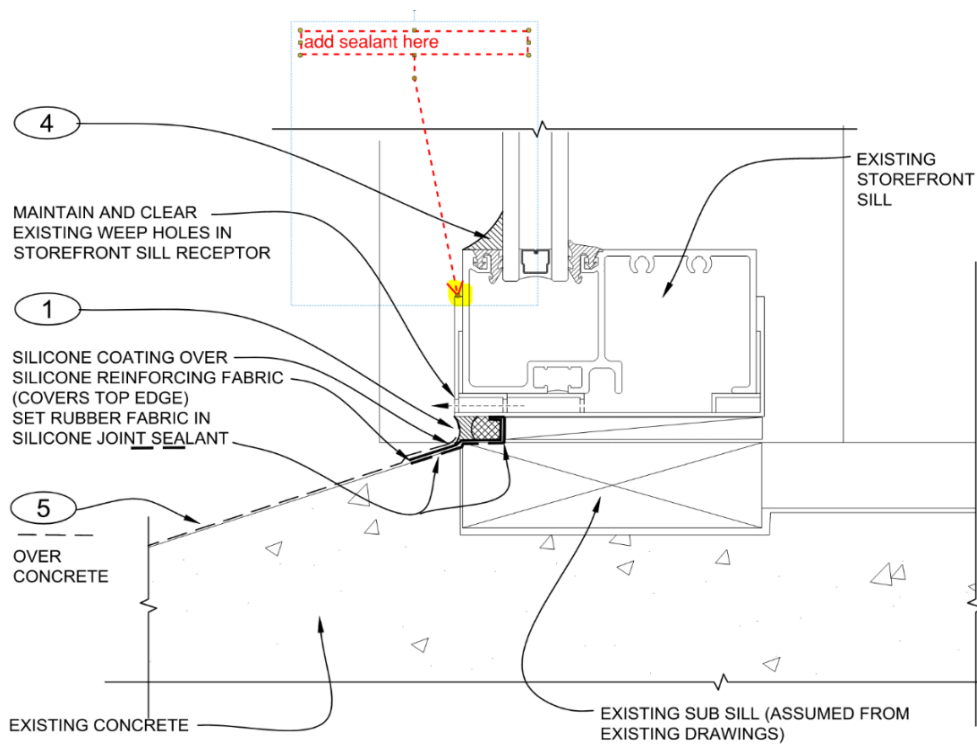

10 STOREFRONT SILL AT CONCRETE BASE

W3.01 SCALE: 6"=12" (do not scale)

